

PIX AUTOMOTIVE BELTS

High Powered Belts for Next-Generation-Engines

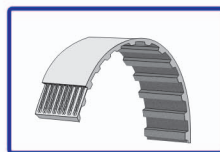
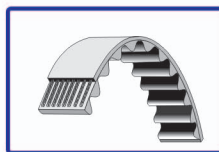
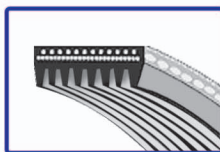
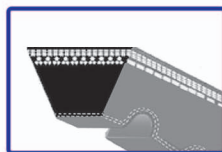

Extensive Range of Belts for

- Cars / Jeeps
- LCV's
- HCV's
- Tractors
- 2&3 Wheelers
- HEMM



X'tra® FORCE AVX-10 1015 La
X'tra® FORCE AVX-10 1015 La

PIX - X'ceed® FORCE-EPDM 4 PK 875
PIX - X'ceed® FORCE-EPDM 4 PK 875
PIX - X'ceed® FORCE-EPDM 4 PK 875

- X'act® FORCE-HNBR 136 PR 25 HSN
- X'act® FORCE-HNBR 136 PR 25 HSN
- X'act® FORCE-HNBR 136 PR 25 HSN

DO NOT FOLD
 TWIST OR CRIMP
 DO NOT FOLD
 TWIST OR CRIMP
 DO NOT FOLD
 TWIST OR CRIMP



PIX EUROPE
 BELTS & HOSES

www.pixeuro.com

PIX GERMANY
 BELTS & HOSES

www.pixeuro.com

PIX SOUTH AMERICA
 BELTS & HOSES

www.pixsam.com

PIX FLEXEQUIP
 HYDRAULICS

www.pixflexequip.com

PIX MIDDLE EAST
 BELTS & HOSES

www.pixme.ae

PIX HYDRAULICS & TRANSMISSIONS

www.pixqcs.com

AN ISO/TS 16949:2002, ISO 14001 & OHSAS 18001 Certified Co.

PIX-X'tra® FORCE Raw Edge Cogged Belts

Features:

- ◆ Best suited for next-generation high speed engines.
- ◆ Engineered and chemically treated modulus & low stretch tensile cords for higher loads without stretch.
- ◆ Fibre reinforced rubber matrix base compound for better grip and lateral rigidity.
- ◆ Excellent resistant to oil and heat, suitable to operate on smaller pulley diameters.
- ◆ Suitable for HEMM (Heavy Earth Moving Machinery) applications.

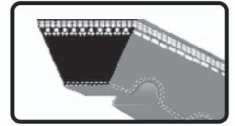

Specifications:

Conforms to BS AU 150b, SAE J 636, JASO E 107.

Sections:

AVX10, HAVX10, AVX13, HAVX13, X13, X15, X17, X20, X25, X11A, X13A, X15A, X17A, X20A, X23A
(All other sections can be made as per the customer's requirement).

PIX-X'ceed® FORCE Ribbed V-Belts

Features:

- ◆ Trapezoid faced ribs on a fibre reinforced rubber matrix for higher power transmission offering good resistance to wear and tear, facilitating quiet running.
- ◆ Reduced vibrations, shock absorber, low stretch and an excellent behaviour under heavy load.
- ◆ Extremely flexible, capable to work on small pulley diameters and serpentine drives.
- ◆ Oil and heat resistant, long service life, suitable for HEMM applications.

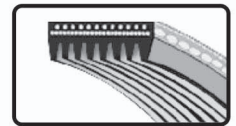

Specifications:

Conforms to ISO 9981, 9982, RMA IP 26 standards.

Sections:

PK / K (Available in EPDM construction also).

PIX-X'act® FORCE Synchronous / Timing Belts

Features:

- ◆ Trapezoidal tooth design for sections ZA, ZB and curvilinear tooth design for other sections.
- ◆ Precisely formed and accurately spaced teeth ensure smooth engagement with pulley grooves.
- ◆ Fibre glass tensile cords provide strength, excellent flex life and high resistance to elongation.
- ◆ Durable backing protects against environmental pollution and friction wear.
- ◆ Tough nylon surface protects tooth surface.

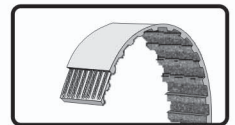
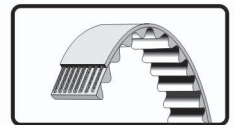

Sections:

ZA, ZB, ZH, PR, PRP, PHP, PRPN, SHPN, CM & YU (Available in HNBR / HSN construction also).

PIX- HEMM Belts

Features:

- ◆ High modulus and stabilised stiff polyester cord.
- ◆ Polychloroprene based compound for antistatic properties.
- ◆ Fibre reinforced based compound for improved transverse stiffness.
- ◆ Oil and heat resistant. Capable to withstand high ambient temperature.
- ◆ Recommended to be used on small pulley diameter and high speed application.
- ◆ Capable to perform in extremely dusty environment.

Range:

Entire range.

We Do "CARE"
Commitment • Ability • Reliability • Efficiency



PIX TRANSMISSIONS LIMITED

Corporate Office:

J-7 M.I.D.C., Hingna Road, Nagpur - 440 016. Maharashtra, India

Tel.: +91-7104-237729 Fax: +91-7104-236505/6

E-mail: info@pixtrans.com Website: www.pixtrans.com

State of the art PIX Bazargan Plant